

Series B Premium - Medical Gas Outlet Front Load DISS Key Style

SPECIFICATION

DISS Medical Gas Outlet

The DISS medical gas outlets are gas specific for the services indicated and accept only corresponding DISS nuts and nipples. The outlets are UL listed and fully compliant with the latest edition of NFPA 99. All outlets are 100% tested for flow, leaks, and connector attachment. The outlets are cleaned for oxygen service in the manufacturing process. The outlets are made in the U.S.A.

Outlet Design

A complete medical gas outlet consists of a gas specific rough-in assembly for installation before the wall or console is completed. A matching gas specific latch valve assembly and trim plate are installed after the finish is complete.

Rough-in Assembly

The rough-in assembly is of modular design and includes a gas specific 16-gauge steel mounting plate. Wall versions permit on site ganging of multiple outlets, in any order, on 5" (12.7cm) centerline spacing. A 3/8" (9.5mm) high metal flange around the outlet opening provides a plaster barrier. A temporary cover is provided to keep debris out of the outlet during installation. Console rough-ins fit standard electrical box cutouts and screw locations.

A machined brass outlet block is permanently attached to the rough-in plate to permit the 1/2" OD (3/8" nominal), type K copper inlet tube to swivel 360° for attachment to the piping system. Gas service identification is affixed to the inlet tube and the face of the rough-in plate.

Check Valve Design

The Series B Premium design contains an internal check valve that may be removed from the front of the outlet and serviced without needing to remove the outlet from its point of installation.

A secondary (ball bearing) check valve located within the valve body of the outlet (except vacuum and WAGD) activates by design when the primary check valve is removed to prevent the flow of gas. An additional check valve remains in the outlet block of the rough-in assembly (except vacuum and WAGD) for both pressure testing and preventing gas flow when the entire latch valve assembly is removed.

The outlet block contains a double seal to prevent gas leakage between the rough-in and latch valve assemblies after the wall is finished. Outlets using a single o-ring seal are not acceptable.

Latch Valve Assembly

The latch valve assembly includes a captured o-ring seal primary valve, it is gas specific for the labeled service, and it accepts only hose and apparatus with DISS nut and nipple adapters. The latch valve assembly is indexed to the corresponding rough-in assembly to avoid accidental cross connection and self-adjusts up to 3/4" (1.9 cm) to allow for variation in finished wall thickness from 1/2" (12.5 mm) up to 1-1/4" (3.175 cm).



Trim Options

Either a die cast, light gray, epoxy powder-coated trim plate or a smaller plastic trim plate can trim each outlet. A hook plate with a retractable arm can also trim each outlet. The die cast plate and hook plate are designed specifically to fill the space between adjacent outlets. The finish of the hook plate is treated with Biomaster*, an additive that is shown to reduce bacteria growth. All trim plates allow latch valves to be individually removed for servicing.

Disclaimer: Use of this product does not protect user from disease-bearing and food-borne pathogens.



Front Load DISS Outlets

(Note: Typical complete outlet consists of a Rough-in, a matching Latch Valve, and a Trim Plate - Standard (325161-00) or Hook Plate (4107 2205 71))

Gas Service	Color Code (Background/Text)	Complete Assembly, Wall Outlet (Standard Trim Plate)	Complete Assembly, Wall Outlet (Hook Trim Plate)	Rough-in Assembly, Wall Outlet	Rough-in Assembly, Console Outlet	Latch-Valve Assembly, Wall or Console
Oxygen	White/Green	4107 2262 10	4107 2262 18	233110-00	233010-00	4107 2261 16
Medical Air	Yellow/Black	4107 2262 11	4107 2262 19	233112-00	233012-00	4107 2261 17
Nitrogen	Black/White	4107 2262 12	4107 2262 20	233114-00	233014-00	4107 2261 18
Carbon Dioxide	Gray/Black	4107 2262 13	4107 2262 21	233120-00	233020-00	4107 2261 19
Nitrous Oxide	Blue/White	4107 2262 14	4107 2262 22	233111-00	233011-00	4107 2261 20
Vacuum	White/Black	4107 2262 15	4107 2262 23	233113-00	233013-00	4107 2261 21
WAGD	Purple/White	4107 2262 16	4107 2262 24	233119-00	233019-00	4107 2261 22
Instrument Air	Red/White	4107 2262 17	4107 2262 25	233118-00	233018-00	4107 2261 23

Accessories

(Note: Good design provides one slide with each vacuum)

Slide (Wall outlet style, Complete)	120978-00	Duplex Electrical Receptacle* (Gray 15A, 125V, Wall outlet style, Complete)	120972-00
Slide (Surface mount style)	135012-00	Trim Plate, Wall (Large) Style	325161-00
Blank, Gas (Complete with RI and finish)	120979-00	Trim Plate, Console (Small) Style	616358-00
Blank, Gas (Cover plate only)	415169-00	Series B Outlet Hook Plate	4107 2205 71

* See specification sheet SSB-840-13 for additional electrical receptacles.

Serviceable Check Valve Components

The Series B Premium design includes a serviceable check valve that allows for replacing the assembly when needed without removing the latch valve from the wall. Each gas uses one of four different serviceable cartridges which can be removed and reinserted using the Series B Premium service tool. The following service kits are available:

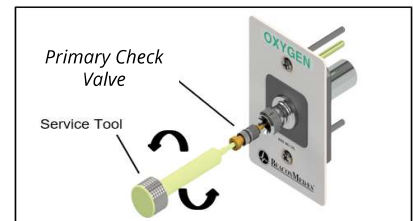

Service Kits			
Service Kit Part Number	Contents		
	Part	Units	Description
4107 4021 60	4107 7933 83	5	Primary Check for Oxygen, Instrument Air
	4107 7933 84	10	Primary Check for Medical Air, Nitrous Oxide, Nitrogen & Carbon Dioxide
	4107 7933 85	5	Primary Check for Vacuum
	4107 7933 86	5	Primary Check for WAGD
	4107 6569 14	1	Service Tool
4107 4021 61	4107 7933 83	10	Primary Check for Oxygen, Instrument Air
	4107 6569 14	1	Service Tool
4107 4021 62	4107 7933 84	10	Primary Check for Medical Air, Nitrous Oxide, Nitrogen, Carbon Dioxide
	4107 6569 14	1	Service Tool
4107 4021 63	4107 7933 85	10	Primary Check for Vacuum
	4107 6569 14	1	Service Tool
4107 4021 64	4107 7933 86	10	Primary Check for WAGD
	4107 6569 14	1	Service Tool
4107 4021 70	4107 6569 14	2	Service Tool

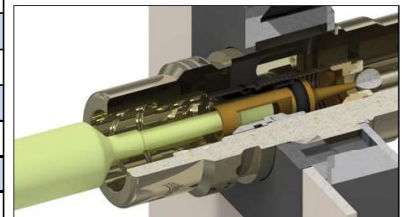

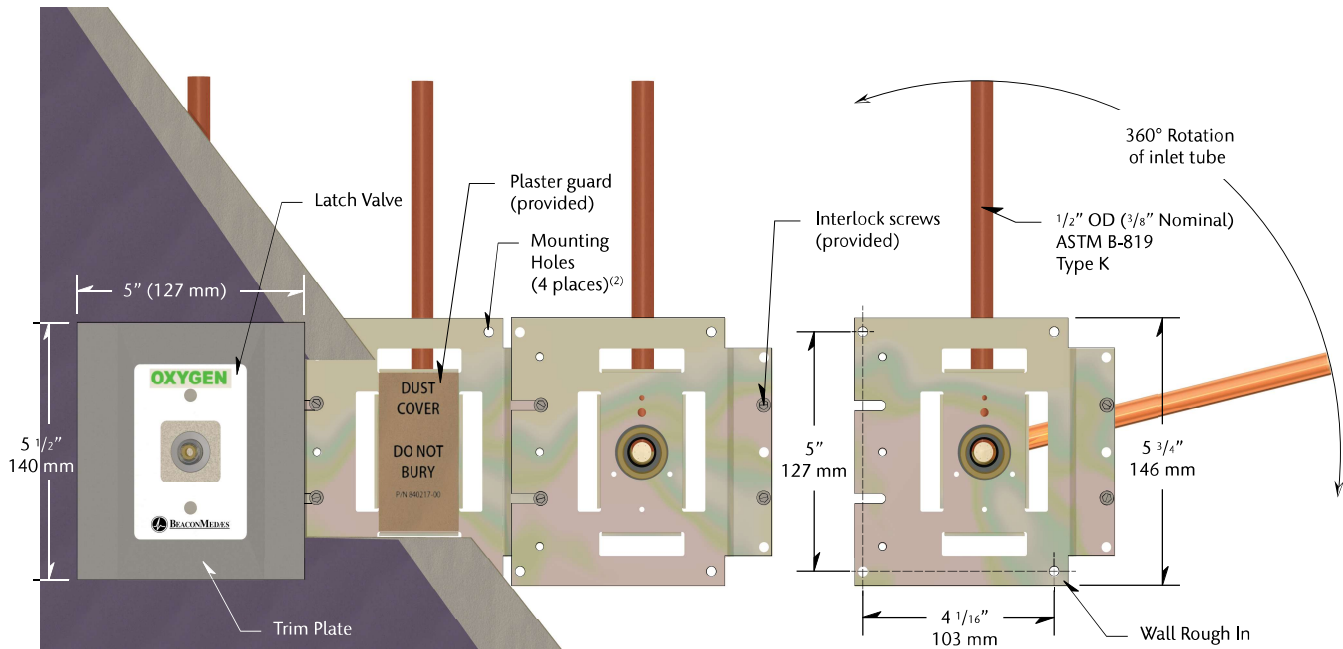

⁽¹⁾ When wallboard is less than 1/2" / 12.5 mm thick, as in consoles and headwalls, console outlets should be considered.

⁽²⁾ Plates may gang together in any length. Up to three may be ganged without additional support, however, top and bottom support is always recommended. Total finished length will be 5" / 127 mm x number of outlets in the gang (e.g. three outlets = 5 x 3 = 15")

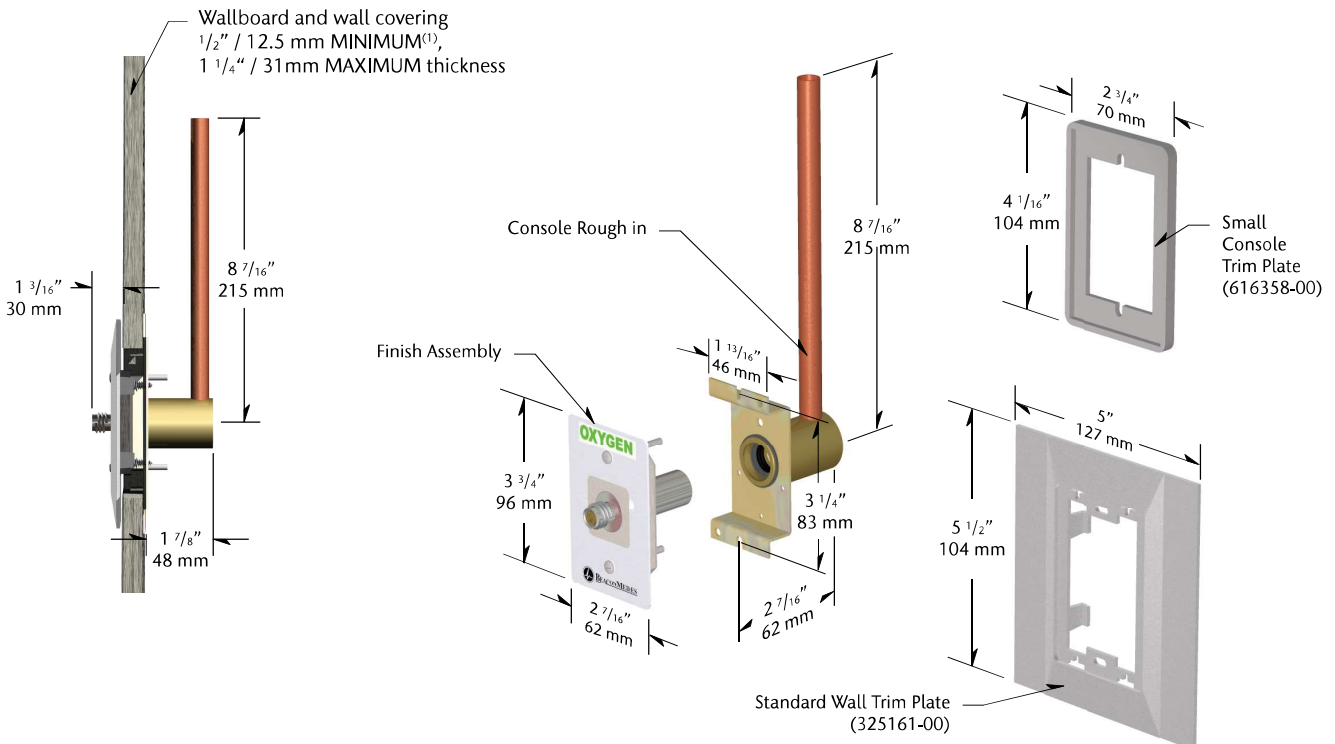

Life is in the details.®

